

M1-ABS/FE

Bourdon tube pressure gauges

Technical Data Sheet



Description

Dry plastic case bottom entry. For general industry, gases and liquids not viscous, not aggressive and not crystallising.



M1-ABS 40/FE

DN40 pressure gauges.

Part No	Pressure Range	Connection	Options*	Box/Master	Min. order
	-1/0 bar/inHg	R1/8		200/200	200
PZFEA110117LF	0-1 bar/psi	R1/8	D+LW+QEN	200/10	10
PZFEA110217LF	0-1.6 bar/psi	R1/8	D+LW+QEN	200/10	10
PZFEA120317LF	0-2.5 bar/psi	R1/8	D+LW+QEN	200/10	10
PZFEA120417LF	0-4 bar/psi	R1/8	D+LW+QEN	200/10	10
PZFEA120617LF	0-6 bar/psi	R1/8	D+LW+QEN	200/10	10
PZFEA121017LF	0-10 bar/psi	R1/8	D+LW+QEN	200/10	10
PZFEA121217LF	0-12 bar/psi	R1/8	D+LW+QEN	200/10	10
PZFEA121617LF	0-16 bar/psi	R1/8	D+LW+QEN	200/10	10
PZFEA122017LF	0-20 bar/psi	R1/8	D+LW+QEN	200/10	10
PZFEA122517LF	0-25 bar/psi	R1/8	D+LW+QEN	200/10	10
PZFEA124017LF	0-40 bar/psi	R1/8	D+LW+QEN	200/10	10



M1-ABS 50/FE

DN50 pressure gauges.

Part No	Pressure Range	Connection	Options*	Box/Master	Min. order
PZFEA219918LF	-1/0 bar/inHg	R1/4	D+LW+QEN	100/10	10
PZFEA210118LF	0-1 bar/psi	R1/4	D+LW+QEN	100/10	10
	0-1.6 bar/psi	R1/4		100/100	100
PZFEA220318LF	0-2.5 bar/psi	R1/4	D+LW+QEN	100/10	10
PZFEA220418LF	0-4 bar/psi	R1/4	D+LW+QEN	100/10	10
PZFEA220618LF	0-6 bar/psi	R1/4	D+LW+QEN	100/10	10
PZFEA221018LF	0-10 bar/psi	R1/4	D+LW+QEN	100/10	10
PZFEA221218LF	0-12 bar/psi	R1/4	D+LW+QEN	100/10	10
PZFEA221618LF	0-16 bar/psi	R1/4	D+LW+QEN	100/10	10
PZFEA222018LF	0-20 bar/psi	R1/4	D+LW+QEN	100/10	10
	0-25 bar/psi	R1/4		100/100	100
PZFEA220617LF	0-6 bar/psi	R1/8	D+LW+QEN	100/10	10
PZFEA221017LF	0-10 bar/psi	R1/8	D+LW+QEN	100/10	10
PZFEA221217LF	0-12 bar/psi	R1/8	D+LW+QEN	100/10	10



M1-ABS 63/FE

DN63 pressure gauges.

Part No	Pressure Range	Connection	Options*	Box/Master	Min. order
PZFEA319918LF	-1/0 bar/inHg	R1/4	D+LW+QEN	100/10	10
PZFEA310118LF	0-1 bar/inHg	R1/4	D+LW+QEN	100/10	10
PZFEA310218LF	0-1.6 bar/psi	R1/4	D+LW+QEN	100/10	10
PZFEA320318LF	0-2.5 bar/psi	R1/4	D+LW+QEN	100/10	10
PZFEA320418LF	0-4 bar/psi	R1/4	D+LW+QEN	100/10	10
PZFEA320618LF	0-6 bar/psi	R1/4	D+LW+QEN	100/10	10
PZFEA321018LF	0-10 bar/psi	R1/4	D+LW+QEN	100/10	10
PZFEA321218LF	0-12 bar/psi	R1/4	D+LW+QEN	100/100	10
PZFEA321618LF	0-16 bar/psi	R1/4	D+LW+QEN	100/10	10
PZFEA322018LF	0-20 bar/psi	R1/4	D+LW+QEN	100/10	10
PZFEA322518LF	0-25 bar/psi	R1/4	D+LW+QEN	100/10	10
PZFEA324018LF	0-40 bar/psi	R1/4	D+LW+QEN	100/10	10

*Options included

D = Dual scale bar/psi (black/red)

LW = Watts logo on the dial

EN = Dial according to EN-837-1

Customizations per minimum order quantity

Customizations	Model
Customized dials, other scale ranges or connections on request	M1-ABS/FE 40/50/63

Features

Materials	
Case	Black plastic
Window	Clear plastic
Dial	Aluminium
Pointer	Aluminium
Pressure connection	Cu-alloy, 12 mm flats (DN 40) - 14 mm (\geq DN 50) flats
Pressure element	Bourdon tube Cu-alloy, soft soldered \leq 60 bar C-type, > 60 bar helical type Sn-Ag soldered
Movement	Cu-alloy

Technical features	
Design	EN 837-1
Working pressure	Steady: 75% of full scale value Fluctuating: 60% of full scale value Short time: full scale value
Temperature limits	Ambient: -40 ... +60 °C Medium: +60 °C maximum Storage: -40 ... +60 °C
Temperature effect	Deviation from reference temperature (+20°C): $\pm 0,04\%/1K$ of the span
Accuracy class	CI 2.5
Degree of protection	IP 31 per EN 60 529 / IEC 529
Individual weight:	
M1-ABS 40	0.042 kg
M1-ABS 50	0.073 kg
M1-ABS 63	0.089 kg

Overall dimensions (mm)

M1-ABS 40/FE

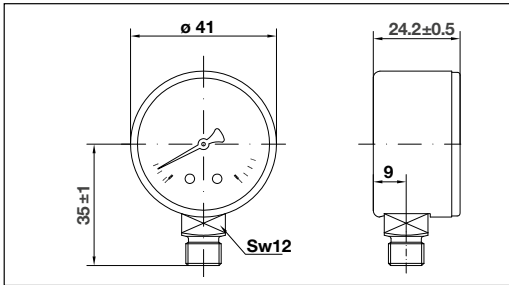

M1-ABS 50/FE

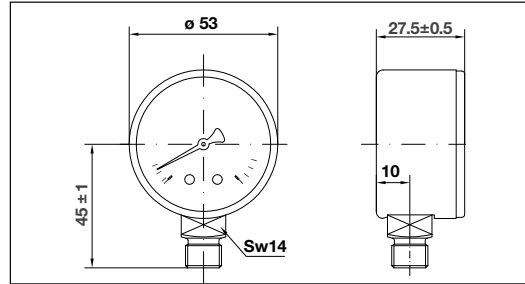

M1-ABS 63/FE

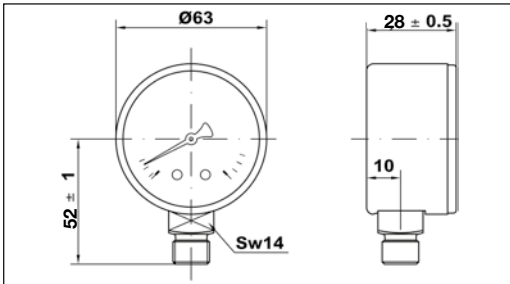

Specification text

Bourdon tube pressure gauges **M1-ABS/FE Series** - brand WATTS - for general industry, gases and liquids not viscous, not aggressive and not crystallising. Dry **plastic case** DN 40-50-63 mm **bottom entry**. Vacuum measures range -1/0, high pressure up to 400 bar. Temperature limits + 60°C. Accuracy class 2.5.

Compliant with EN 837-1.

The descriptions and photographs contained in this product specification sheet are supplied by way of information only and are not binding.

Watts Industries reserves the right to carry out any technical and design improvements to its products without prior notice. Warranty: All sales and contracts for sale are expressly conditioned on the buyer's assent to Watts terms and conditions found on its website at www.wattswater.eu. Watts hereby objects to any term, different from or additional to Watts terms, contained in any buyer communication in any form, unless agreed to in a writing signed by an officer of Watts.

WATTS®



Watts Industries Italia S.r.l.

Via Brenno, 21 • 20853 Biassono (MB) • Italy
Tel. +39 039 4986.1 • Fax +39 039 4986.222
infowattitalia@wattswater.com • www.watts.com