

Collective thermostatic mixing valves eurotherm T9715 - T9107



Chromed finish

*Integrated
check-valves
and strainers*



White finish

- Apparent device recommended for all applications where the mixed water temperature must be kept exact and constant, and adjusted at any time.
- Scald protection: immediate and very powerful.
- T9715 and T9107 are guaranteed 2 years
- Thermostatic mixing valve with low flow rate for sanitary points of use : showers, washbasins, electronic tap ; industrial uses, chilled water applications.

 **WATTS[®]**
INDUSTRIES

A Division of Watts Water Technologies Inc.

Integrated
check-valves
and strainers



Professional products at the service of professionals:

- **Comfort** : the water temperature obtained is accurate to within one degree. Individually checked in the factory, Trubert mixing valves must be calibrated before first use. An exclusive knob mounting system makes this calibration easy. Temperature regulation and stability are excellent, regardless of variations in pressure (max. 1.5 bar), mixing valve inlet temperature and flow rate.
- **Extremely simplified installation** : no special tools are required ; the hot water inlet is fitted on the left, with the mixed water outlet in vertical position. Trubert mixing valves can be placed in various positions without making the temperature difficult to read...
- **Scald protection** : the hot water is rapidly cut if the cold water supply is interrupted.
- **Very easy maintenance** : the durability and scale resistance of Trubert mixing valves ensure that maintenance is virtually nil. The cartridge can be easily replaced without dismantling the mixing valve.

Simple to install. Economical to use.

Purpose:

Apparent device recommended for all applications where the mixed water temperature must be kept exact and constant, and adjusted at any time.

Thermostatic mixing valve with low flow rate for sanitary points of use : showers, washbasins, electronic tap ; industrial uses, chilled water applications.

Options:

Designed to adapt to all specific demands for water at a precise temperature, even at very low flow rate. Several setting ranges : 15/50°C, 40/80°C or 5/40°C.

Protection against Legionella:

- Cartridge can be removed and replaced (for easier scale removal and disinfecting).
- Integral approved check-valves (withstanding temperatures above 90°C).
- Various thermal flash possibilities : use in the 40/80°C range or remove the temperature knob and turn the cartridge to the maximum hot position allowing the water to flow at a hot temperature.

Range:

Diameter M 1/2" (15x21).

flow rate (L/min)	diameter	points of use*	adjustment range	finish	code ref.	weight
mini 3 - maxi 42	M 1/2" 15x21	1 to 5	15/50°C	white	T9715B	1,00 kg
mini 3 - maxi 42	M 1/2" 15x21	1 to 5	40/80°C	white	T9715B48	1,00 kg
mini 3 - maxi 42	M 1/2" 15x21	1 to 5	5/40°C	white	T9715B04	1,00 kg
mini 3 - maxi 42	M 1/2" 15x21	1 to 5	15/50°C	chromed	T9715C	1,00 kg
mini 3 - maxi 42	M 1/2" 15x21	1 to 5	40/80°C	chromed	T9715C48	1,00 kg
mini 3 - maxi 42	M 1/2" 15x21	1 to 5	5/40°C	chromed	T9715C04	1,00 kg

Diameter M 3/4" (20x27).

flow rate (L/min)	diameter	points of use*	adjustment range	finish	code ref.	weight
mini 3 - maxi 42	M 3/4" 20x27	1 to 5	15/50°C	white	T9107B	1,02 kg
mini 3 - maxi 42	M 3/4" 20x27	1 to 5	40/80°C	white	T9107B48	1,02 kg
mini 3 - maxi 42	M 3/4" 20x27	1 to 5	5/40°C	white	T9107B04	1,02 kg
mini 3 - maxi 42	M 3/4" 20x27	1 to 5	15/50°C	chromed	T9107C	1,02 kg
mini 3 - maxi 42	M 3/4" 20x27	1 to 5	40/80°C	chromed	T9107C48	1,02 kg
mini 3 - maxi 42	M 3/4" 20x27	1 to 5	5/40°C	chromed	T9107C04	1,02 kg

* For information only. Take the coefficient of combined flow into consideration.

Replacement cartridges and cartridge extractor.

diameter	adjustment range	code ref.
T9715B, T9715C, T9107B, T9107C	15/50°C	TCP7
T9715, T9107 (04 serie)	5/40°C	TCP704
T9715, T9107 (48 serie)	40/80°C	TCP748
Cartridge extractor		TB120014

Advantages :

This mixing valve with NF approved check valves and filter is very simple and efficient. Easy to operate, it provides savings in hot water while guaranteeing the highest levels of comfort and safety. Scald protection : to prevent scalding, the hot water is instantly cut if the cold water supply is interrupted. The considerable savings in hot water quickly make up the cost of the product.

Technical characteristics:

- Male thread on inlets and outlets, suitable for most plumbing connections.
- Number of outlet : 1.
- Graduated scale handwheel : 15/50°C, 40/80°C or 5/40°C.

The mixing valve is delivered tested and ready to calibrate. Stops supplied in the control knob allow locking on a specific degree or range of temperature.

Caution : Do not subject mixing valves with a temperature range of 5/40°C to a water temperature above 65°C : this may result in irreversible damage.

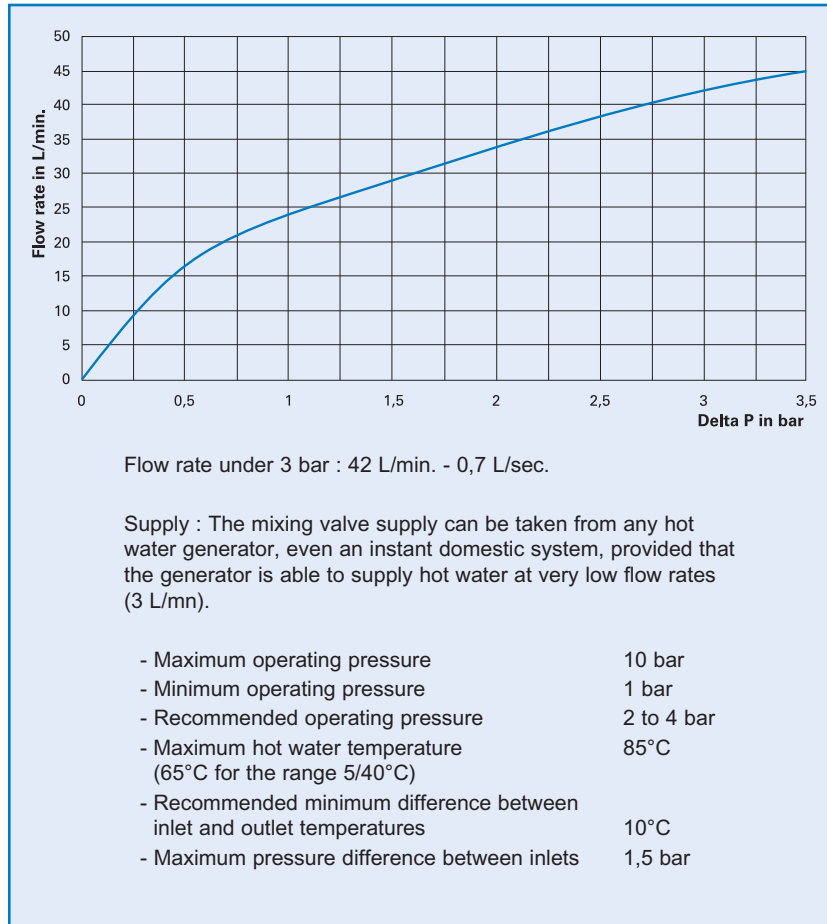

Installation example:

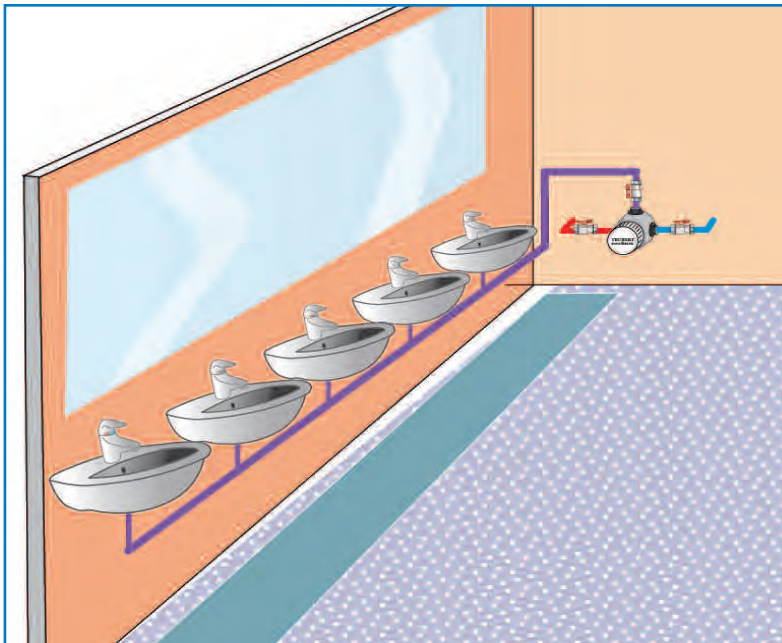

Dimensions:

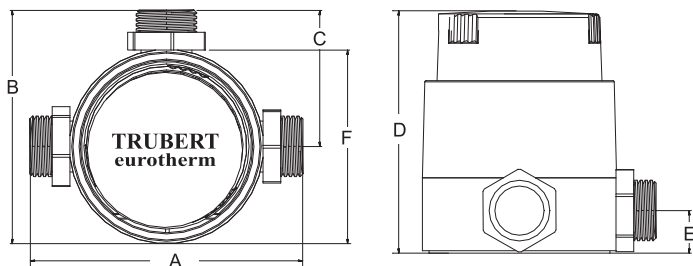

Code ref	T9715	T9107
A (mm)	112	112
B (mm)	96	96
C (mm)	56	56
D (mm)	100	100
E (mm)	17,5	17,5
F (mm)	80	80
diameter	M 1/2"	M 3/4"
weight (kg)	1,00	1,02

Installation:

- Connection : fit stop valves close to the mixing valve, on the inlets at least, to allow the device to be isolated for maintenance or cartridge removal without draining the installation. The valves on the inlets are left fully open during normal use.
- Flush the pipes.
- Calibration : simply move the knob on its indexed shaft until the temperature shown on the knob matches that of the water coming out of the mixing valve.
- It is important to turn the knob smoothly throughout its range.

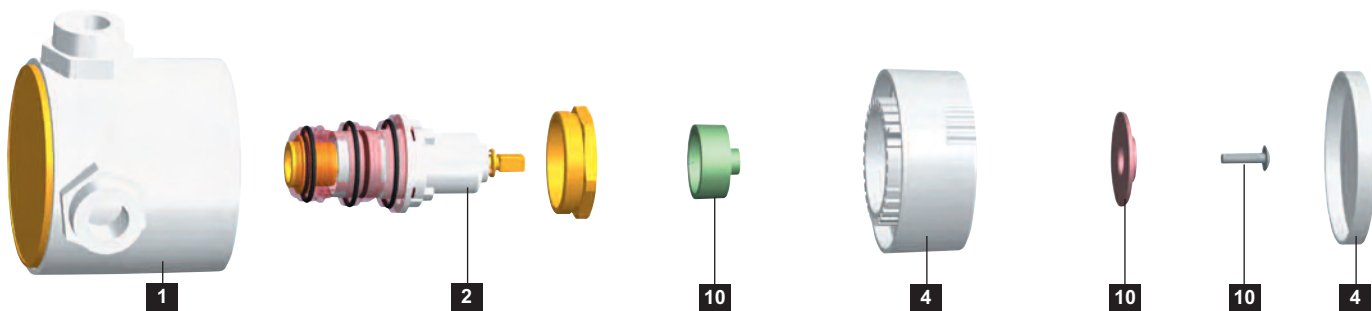

Spare parts:

- | | |
|--|--------------|
| 1 - Body with integrated check valves NF | |
| 2 - Cartridge (15/50°C) | Ref. TCP7 |
| Cartridge (5/40°C) | Ref. TCP704 |
| Cartridge (40/80°C) | Ref. TCP748 |
| 4 - White knob set 15/50°C | Ref. T120715 |
| White knob set 40/80°C | Ref. T120748 |
| White knob set 5/40°C | Ref. T120704 |
| 10 - Knob secure fixing kit | Ref. T120701 |

designation	code ref.
Cartridge extractor	TB120014

The photographs, illustrations and descriptions contained in this brochure are given for information only. Watts Industries reserves the right to change the technical specifications or the design of these products without prior notice.



WATTS INDUSTRIES France

1590 avenue d'Orange CS 10101 SORGUES
 84275 VEDENE cedex - FRANCE
 Tel. +33 (0)4 90 33 28 28 - Fax +33 (0)4 90 33 28 29/39
 www.wattsindustries.com
 E-mail : info@wattsindustries.fr